

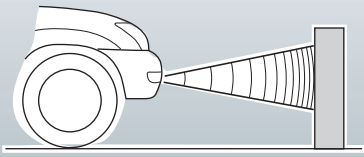

PARK MASTER FRONT F394



Cod. 06DE3787D date 11/2013

Cobra Automotive Technologies
via Astico 41 - 21100 VARESE - ITALY
www.cobra-at.com

1

2

Ø 2 mm
13 mm AV0091
Ø 17 mm
AV0090

> 04/2014

3

PRIMER → SPRAY PAINT → GLOSS

MAX. 70 °C

4 Typical Installation

200-540 mm L1
400-740 mm L2
200-540 mm L3

400+550 mm

T1 + T4

A-A

5

Ø 2 mm

6

D

7

E

180°

G

8

180°

AV0091

Ø 17 mm

9a

9

9b

AV0090

T1 + T4

10

11

12

F

4 3 2 1



13

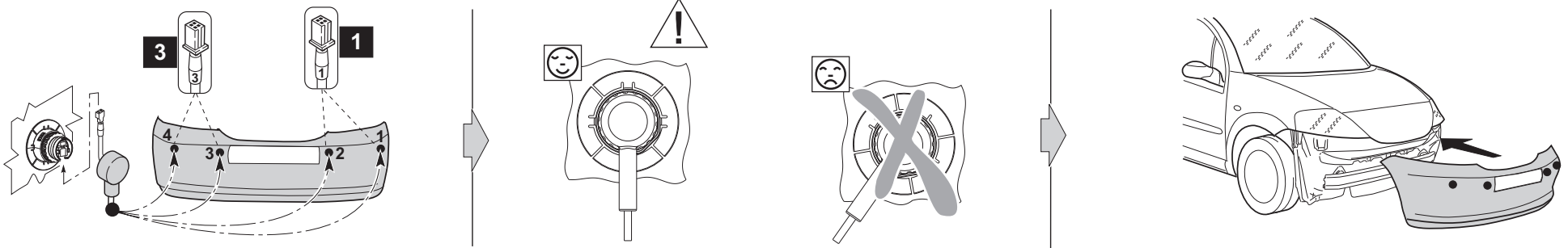

14

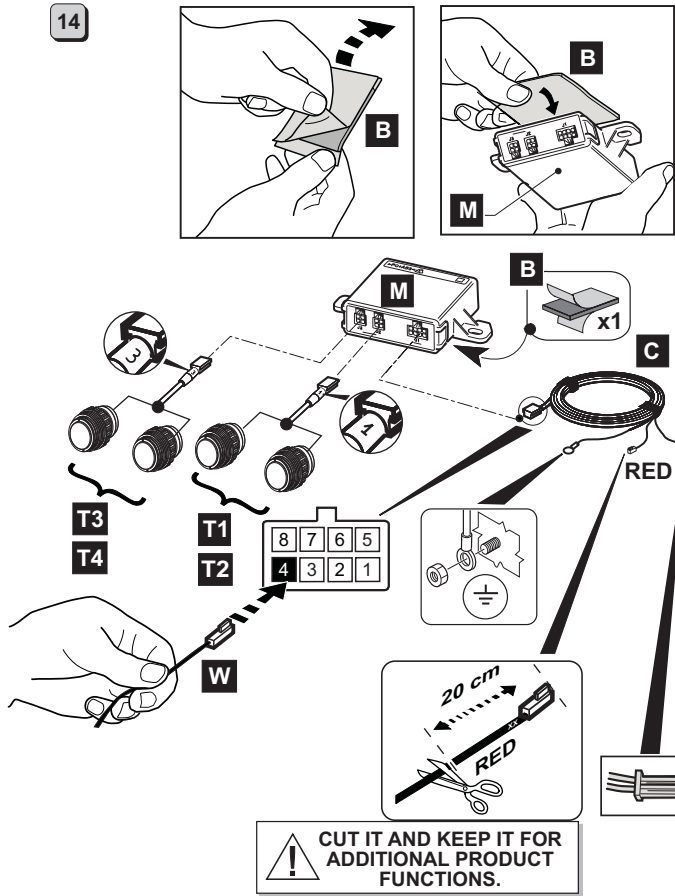

15

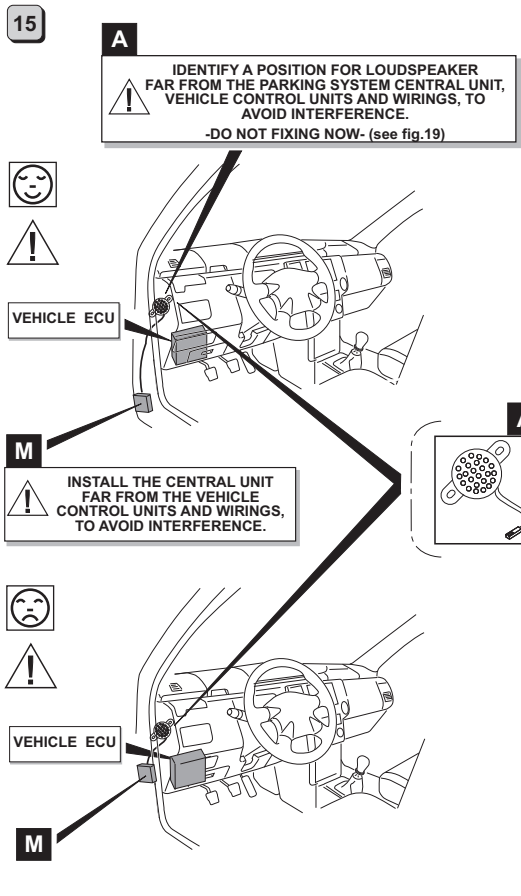

16

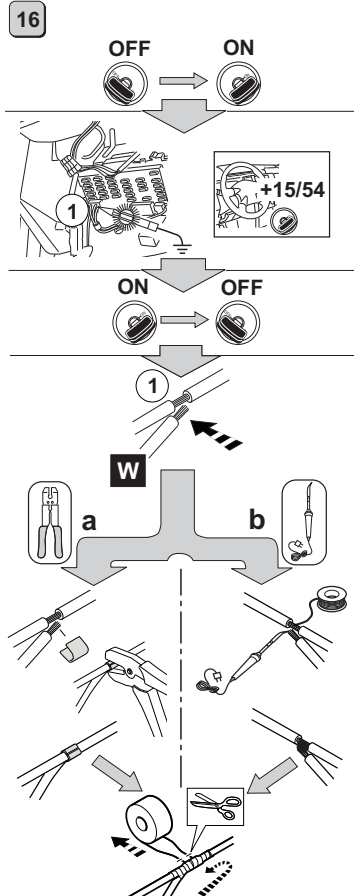

17

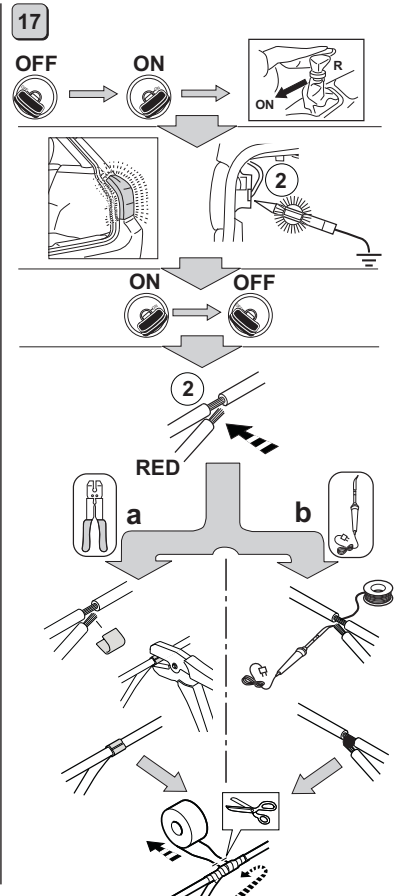

18

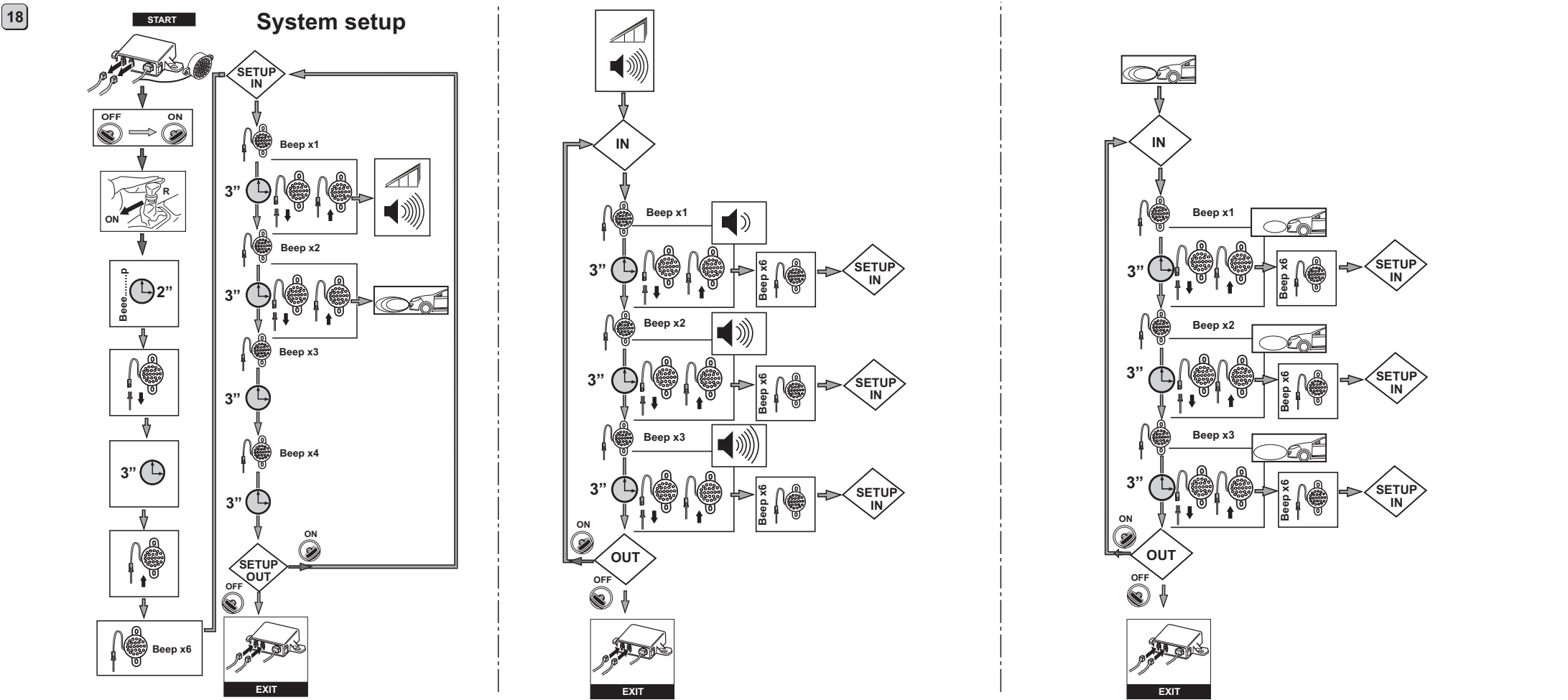

19

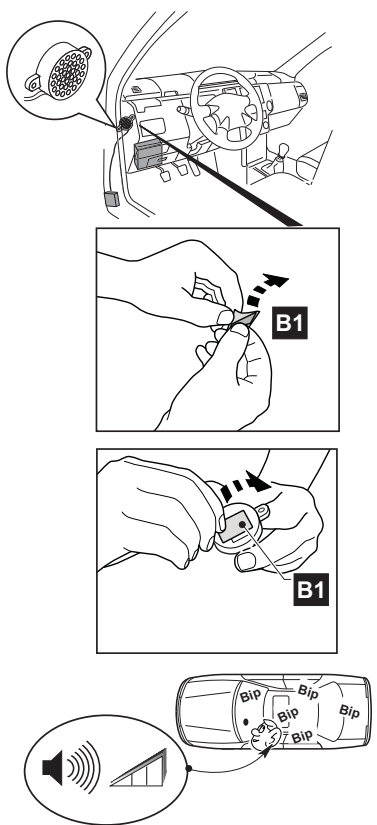

20 System functionality

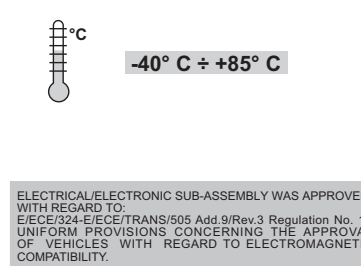
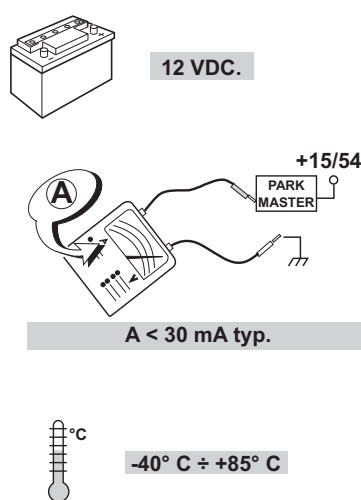
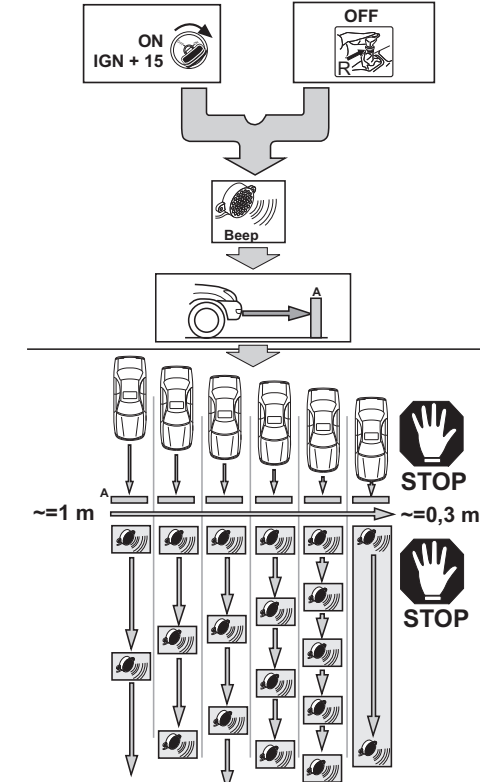

Activation / Deactivation push button.
Order: RV3608EUSAA
(If not contained in the kit)

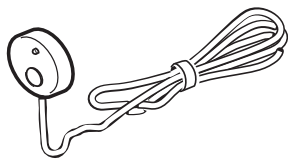

FOR ADDITIONAL FUNCTIONS SEE "INSTALLATION AND CONFIGURATION GUIDE" ON COBRA SITE.