



**THE COMFORT OF HEAT ENSURES A VERY PLEASANT STAY ON BOARD!**

Made in the Netherlands - DURABLE QUALITY

# POST MARINE HEATING CH SYSTEM CALCULATION

FOR CH | COMBI | BOILER CONTROL

SPACE (S) TO BE HEATED	MULTIPLICATION FACTOR GOOD INSULATION / DOUBLE GLAZING	MULTIPLICATION FACTOR POOR INSULATION / SINGLE GLAZING
Deck saloon - wheel-house	120	150
Shower - toilet	120	150
Cabin	100	120
Kitchen	80	100
Sleeping quarters	70	80
Other	50	70

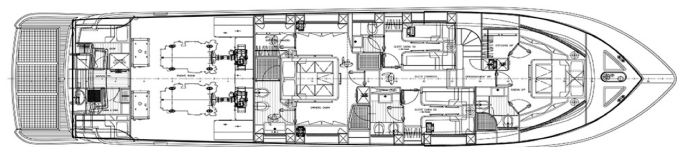

Lower deck

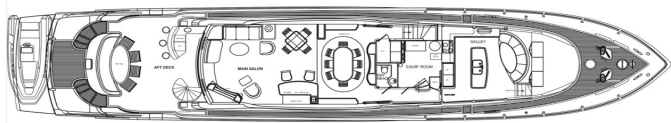

Main deck

The capacity required for a CH system and radiators can be calculated as follows:

1. Work out the volume of the areas to be heated in cubic metres (LxWxH).
2. Multiply the calculated volumes with the values from the table on the left.
3. This gives you the required capacity for each area.
4. Add together all calculated / required capacities.
5. Add 10% to the total boiler capacity.
6. This gives you the total required capacity of the system in Watts.
7. Add 15% to the total boiler capacity when the central heating system is connected in combination with underfloor heating.

*These factors allow you to heat your vessel pleasantly all year round. Post Marine Heating can also advise you on the correct installation materials, the radiators and plinth heaters that are required, or the possibilities of underfloor heating.*



Post Marine B.V.  
Boezem 20a  
4206 CB Gorinchem, Netherlands

+31 (0)183 - 610 211  
info@postmarineheating.com  
www.postmarineheating.com



