

# Valeo

## beep&park

PARKING ASSISTANCE System  
Système d'AIDE AU STATIONNEMENT  
Sensore di PARCHEGGIO  
Sistema de AYUDA PARA ESTACIONAMIENTO  
Sistema de AUXÍLIO DE ESTACIONAMENTO  
EINPARKHILFE-System

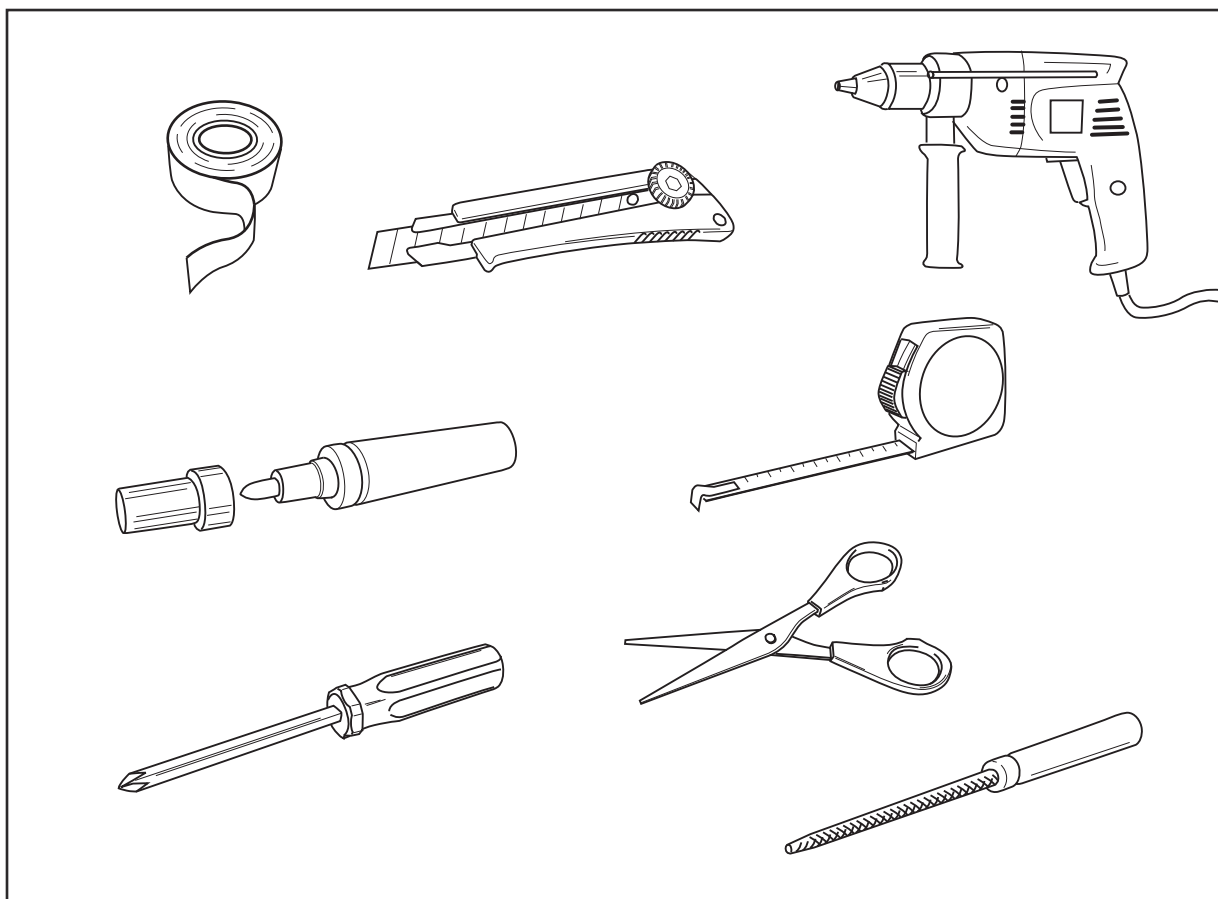
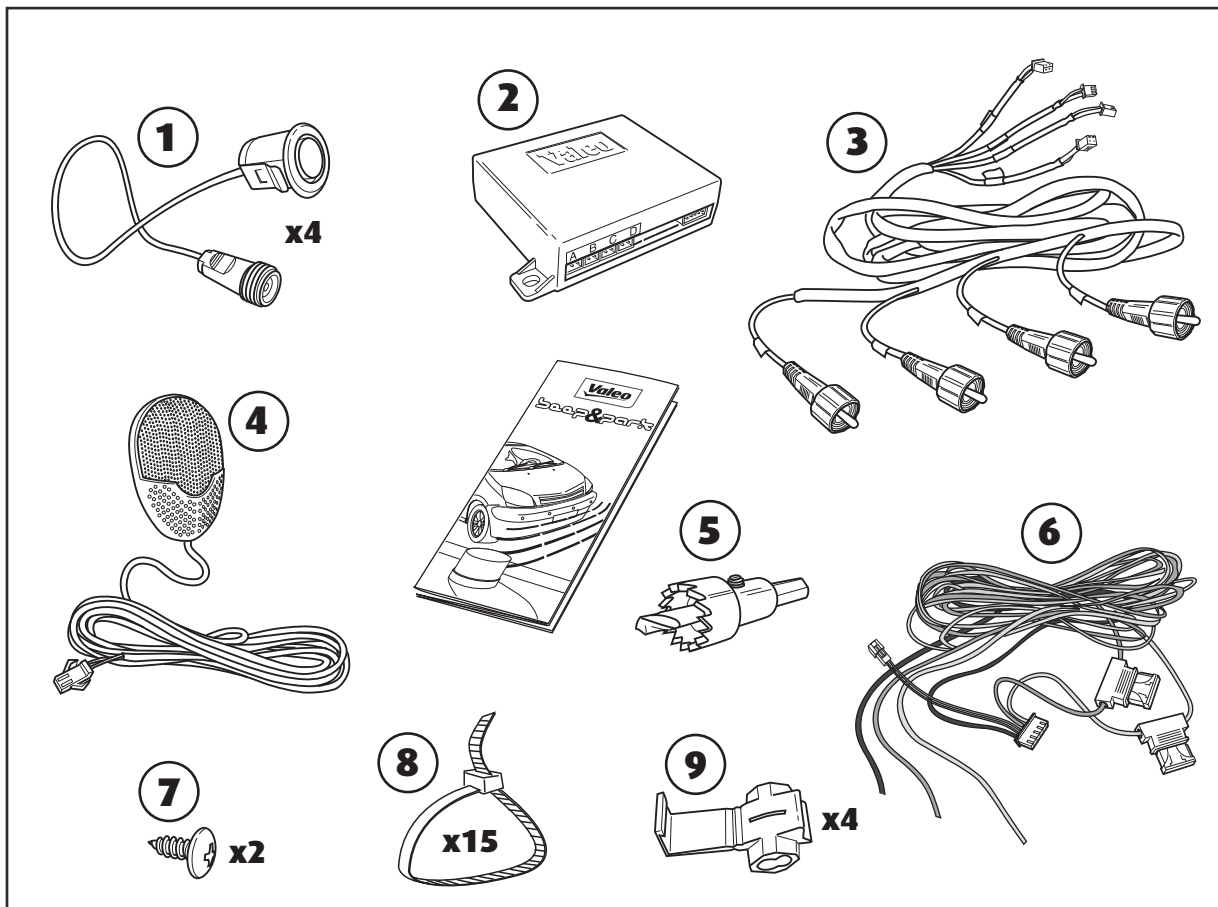
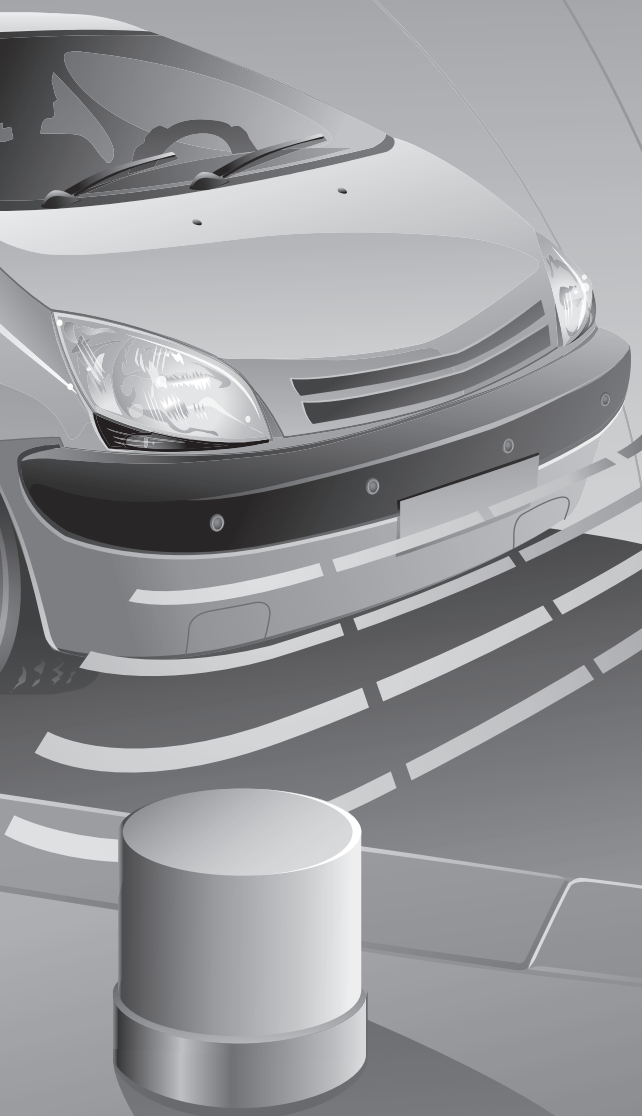

632003



**OK**

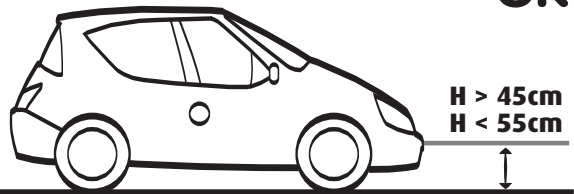

**OK**

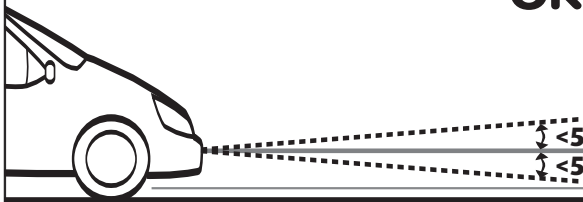

~~**OK**~~

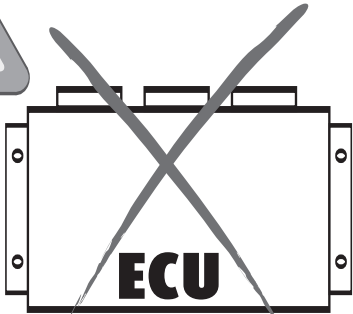
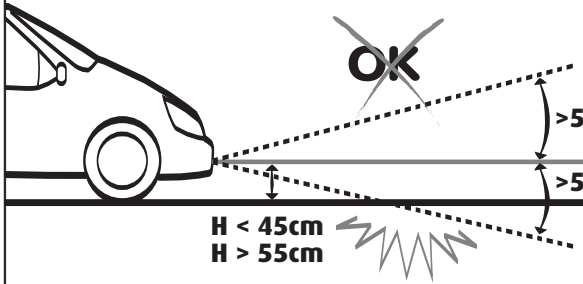

**ECU**

**No Reset Necessary**  
**Réinitialisation non nécessaire**

**1**

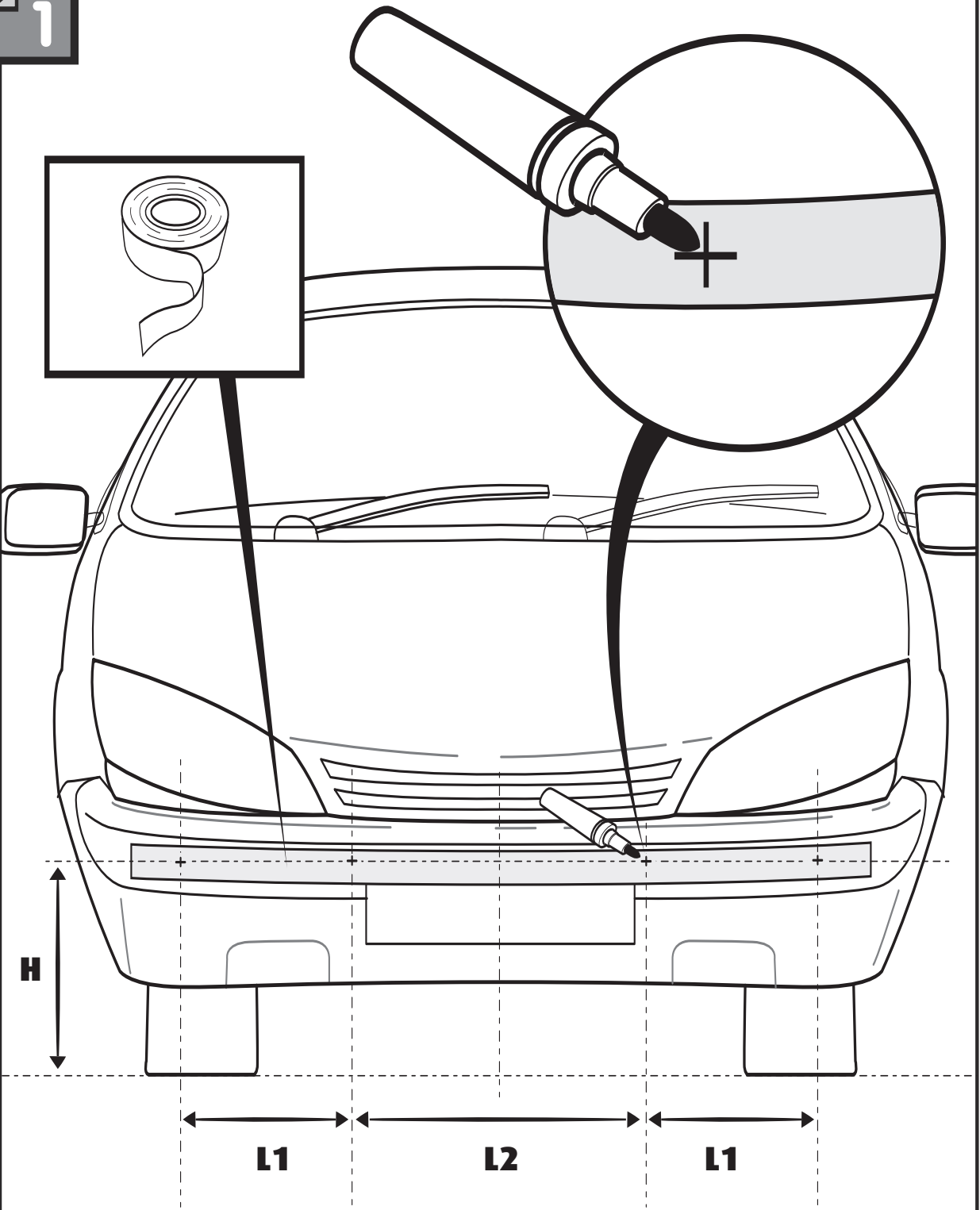

**L1**

**L2**

**L1**

**38cm < L1 < 45cm**  
**50cm < L2 < 76cm**  
**45cm < H < 55cm**

2

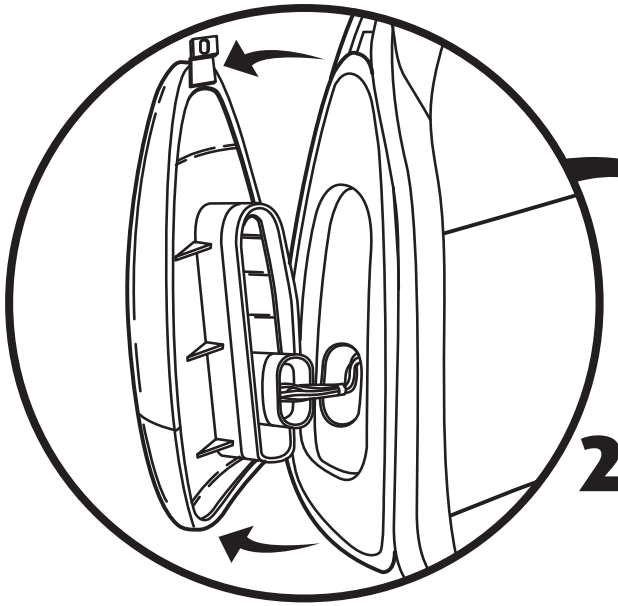
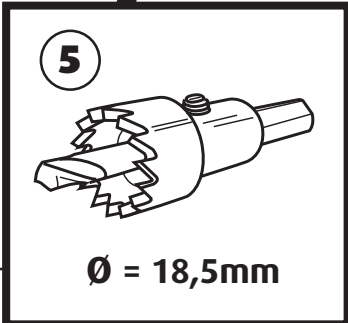
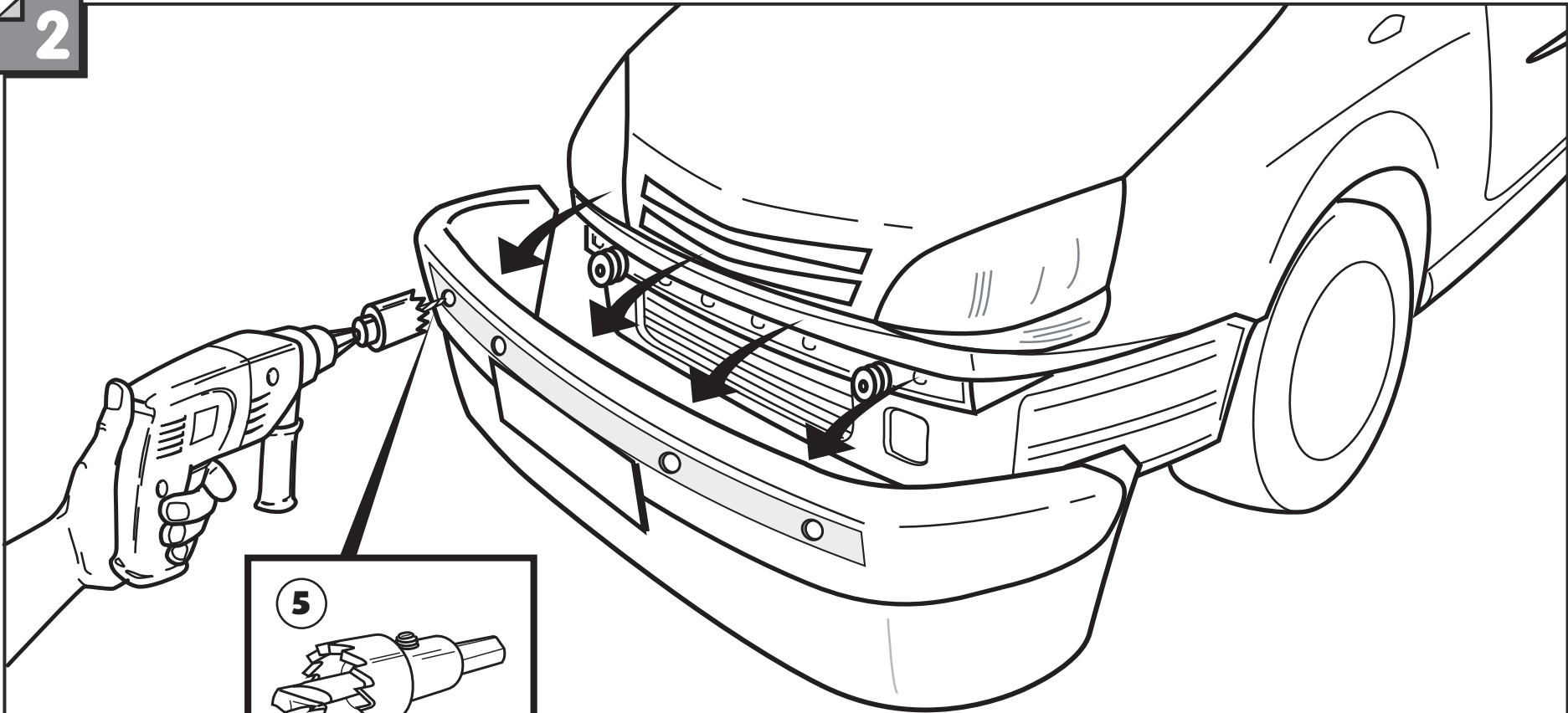

2

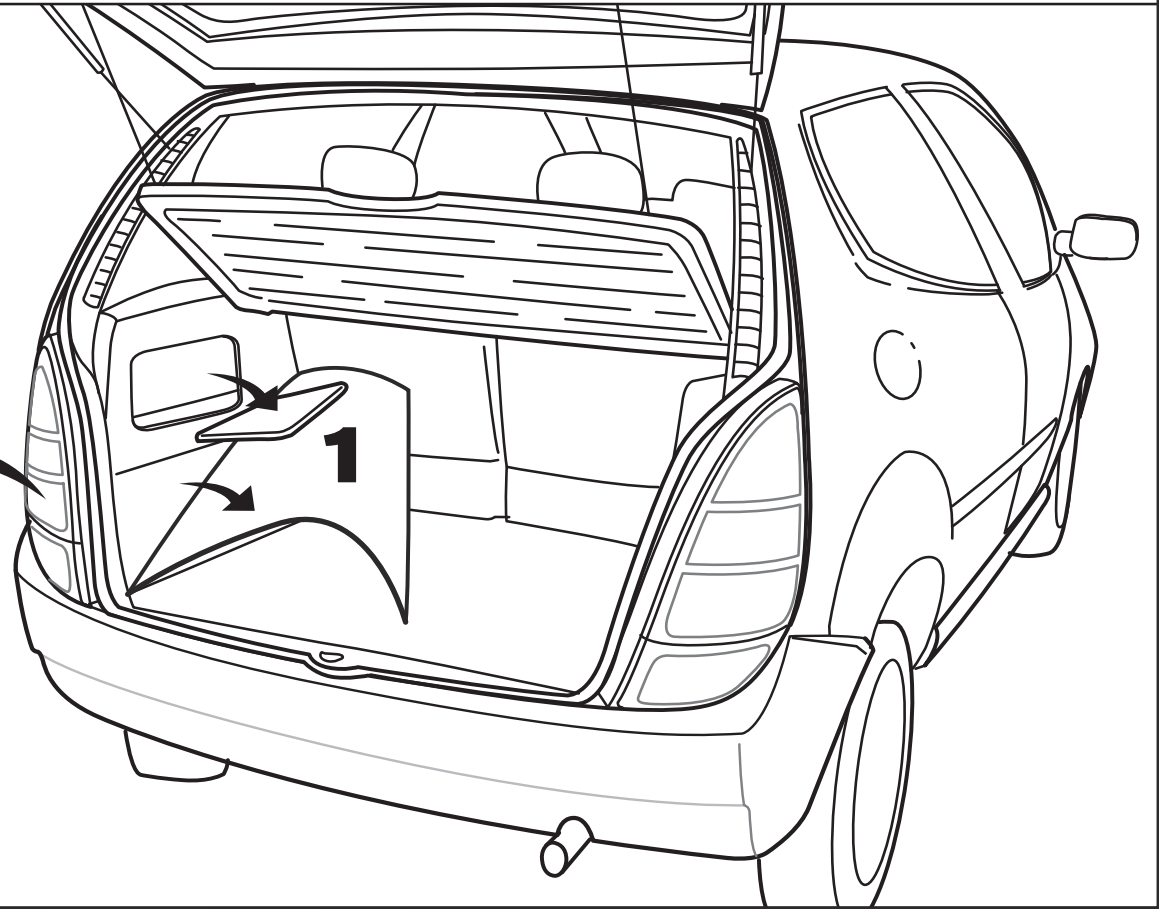

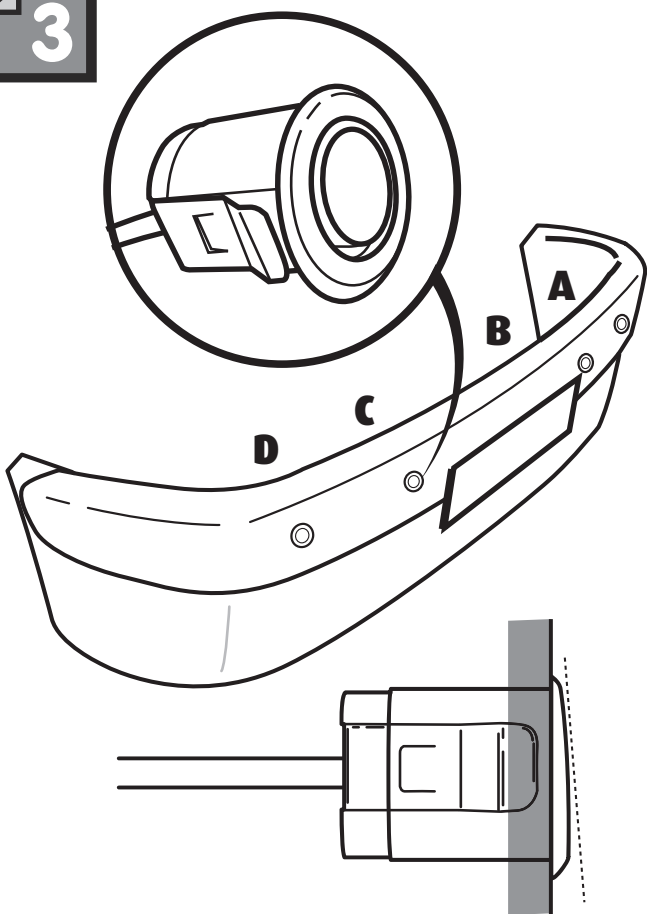
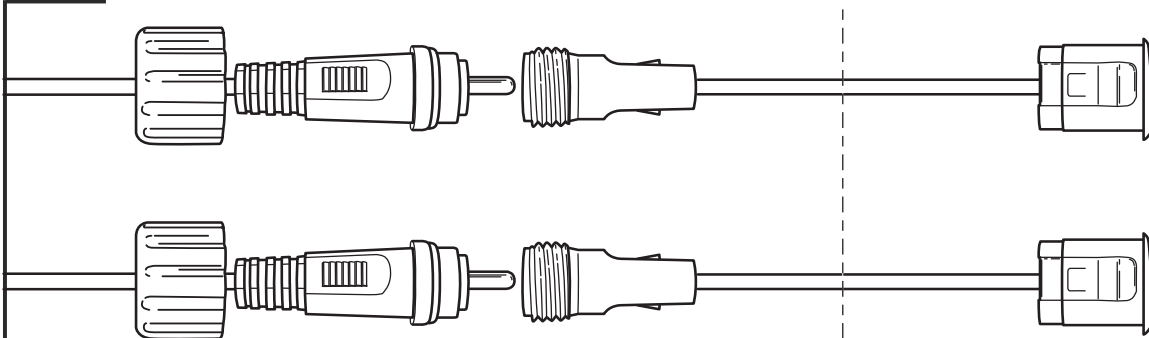
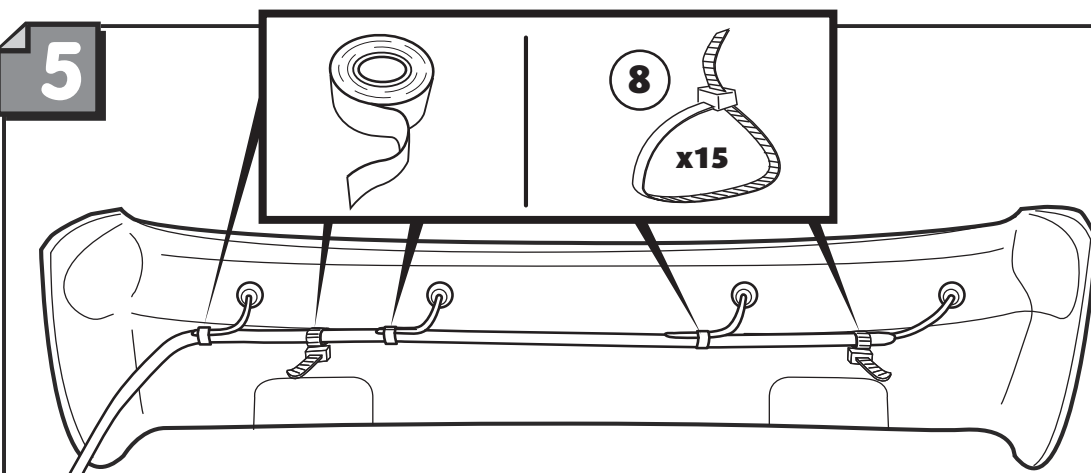
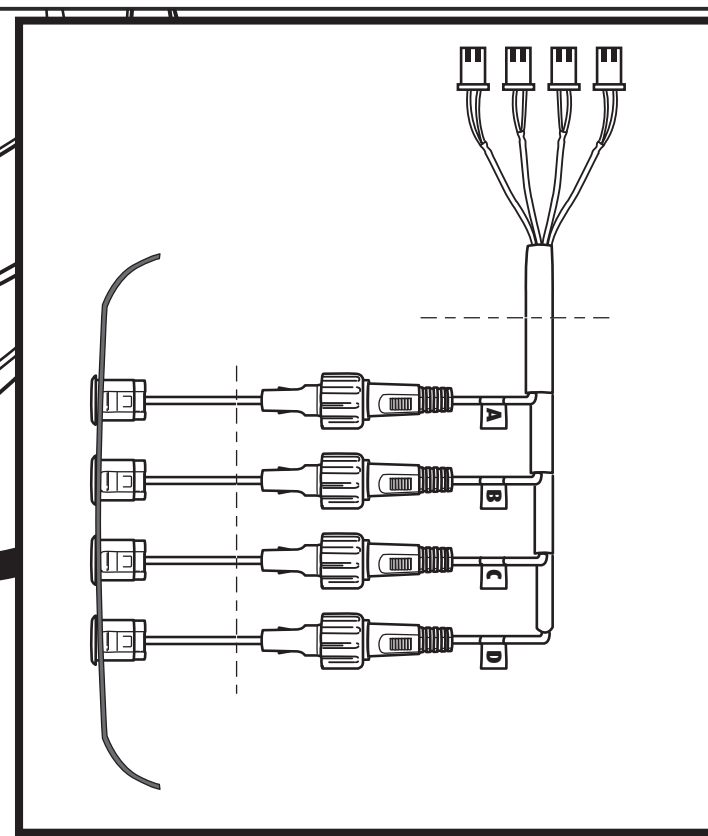
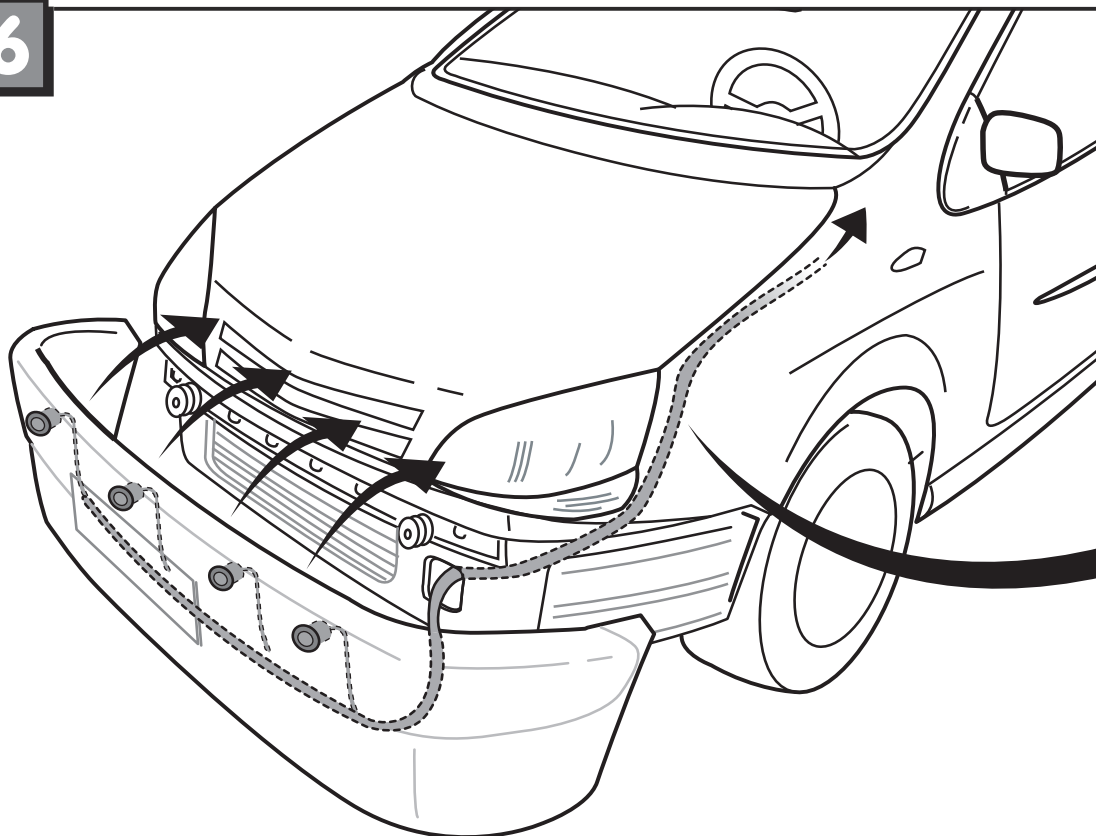
**3****4****5****6**

7

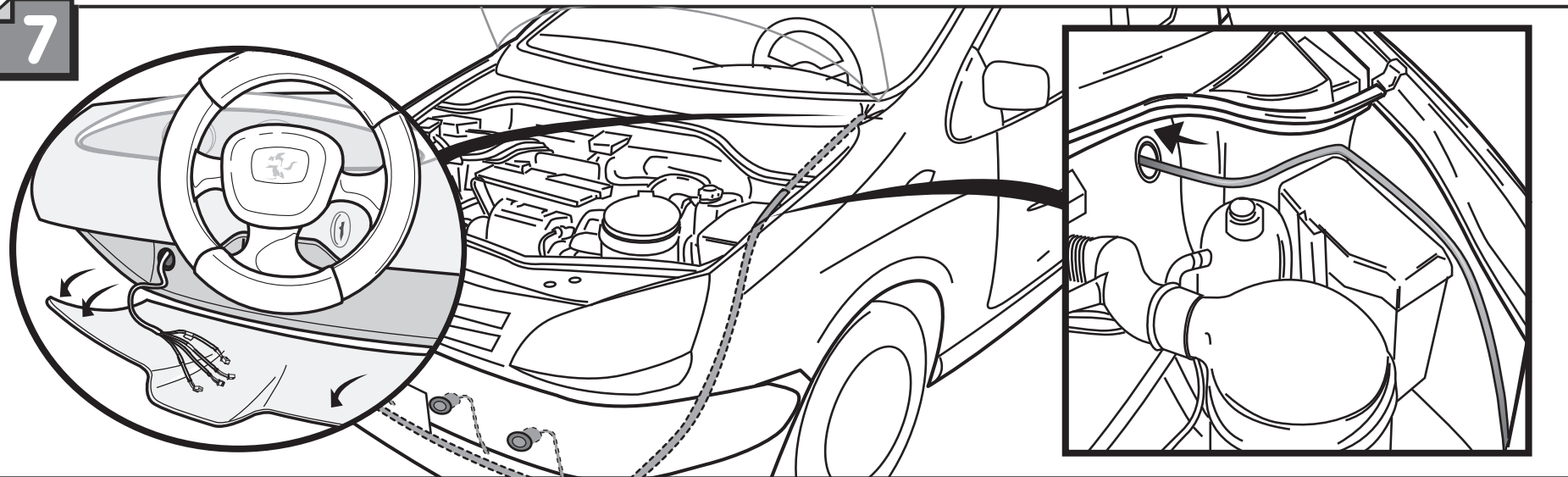

8

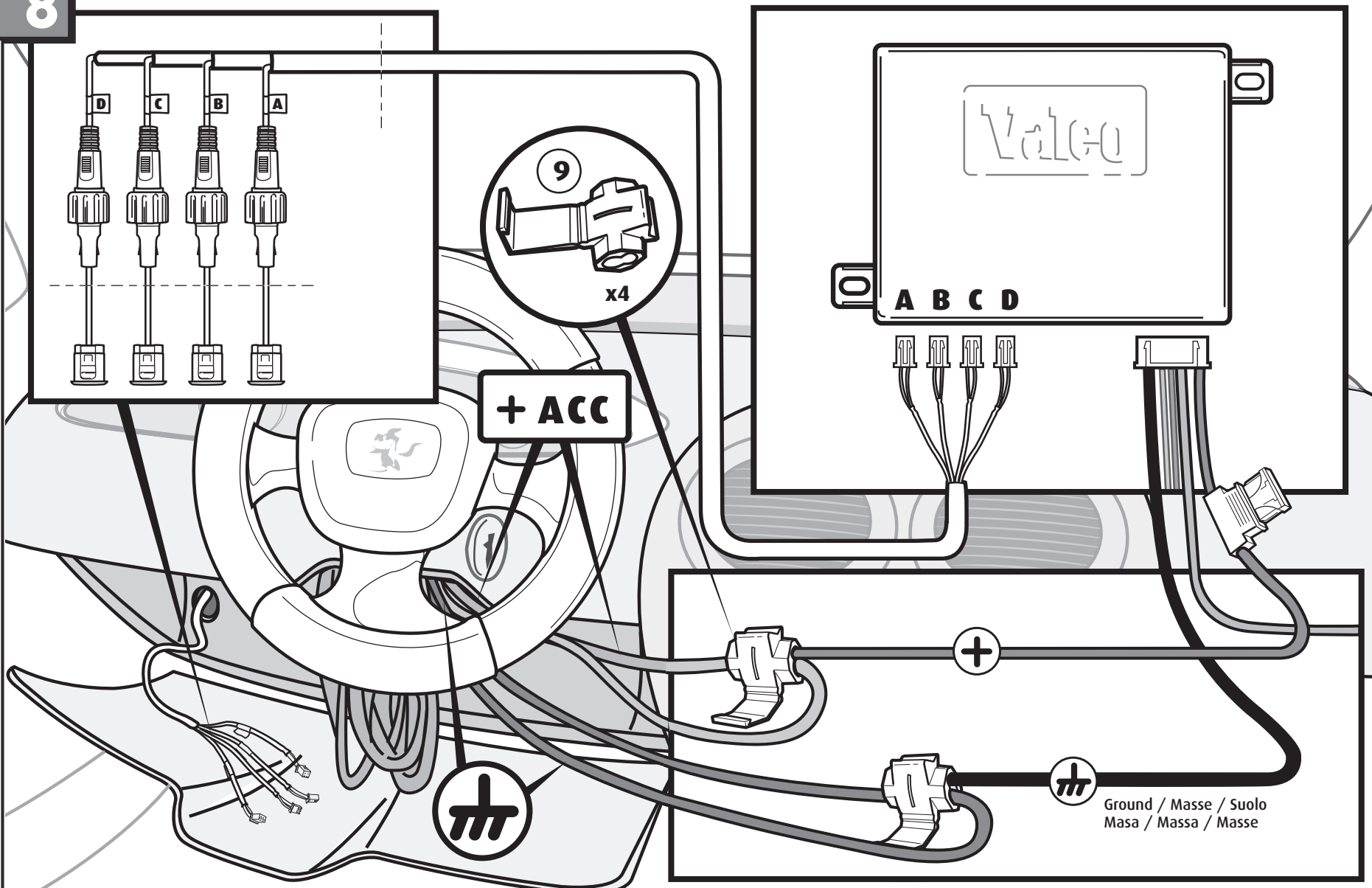



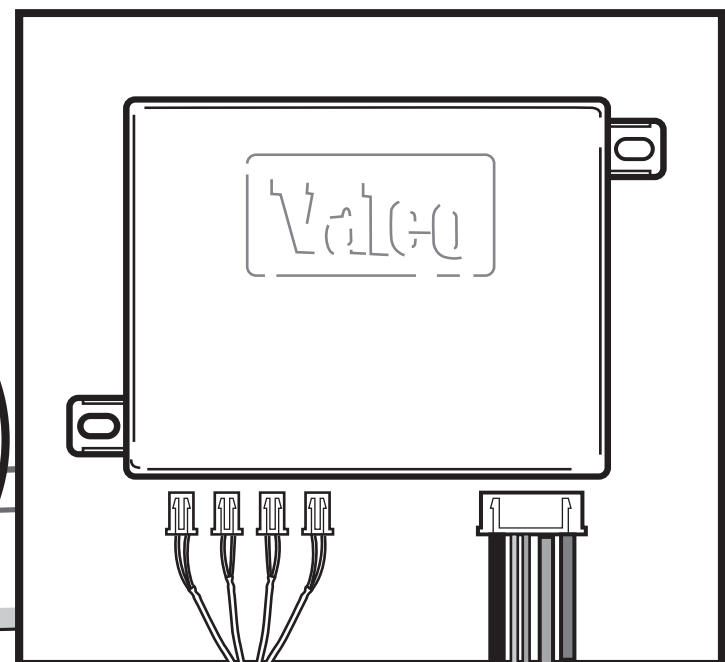
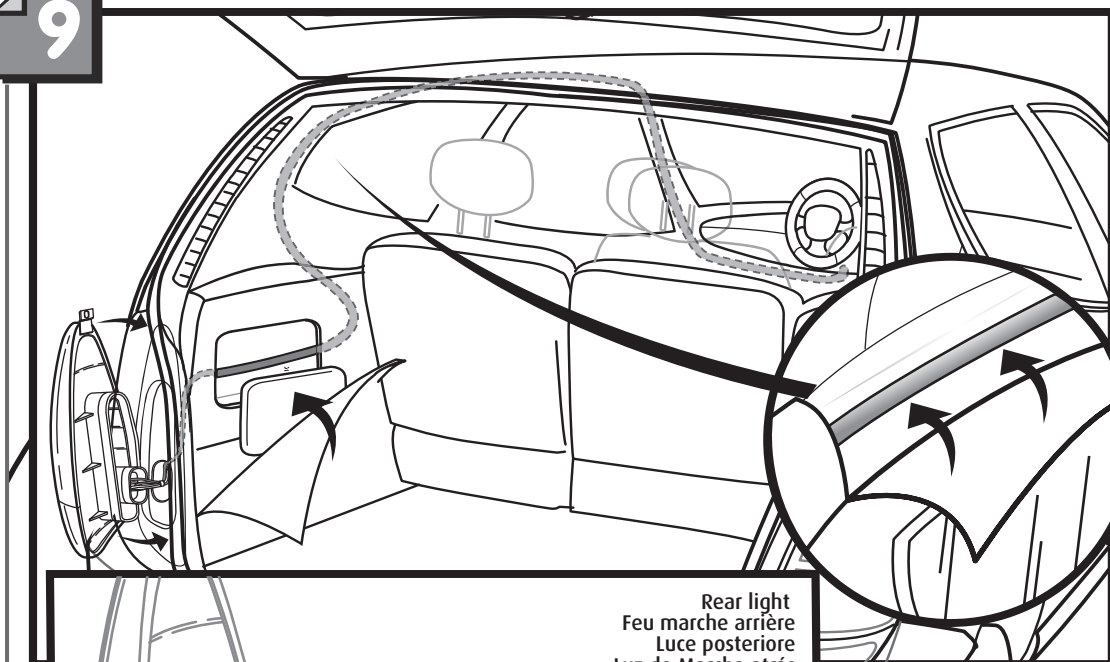

Rear light  
 Feu marche arrière  
 Luce posteriore  
 Luz de Marcha atrás  
 Rückfahrcheinwerfer

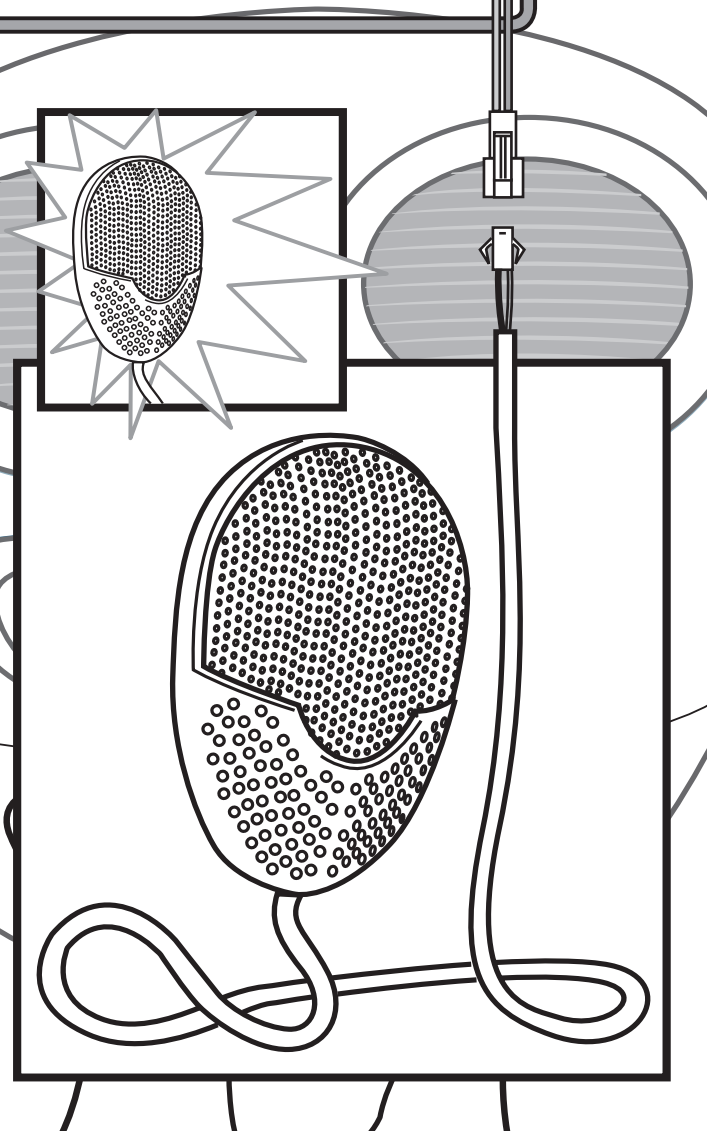
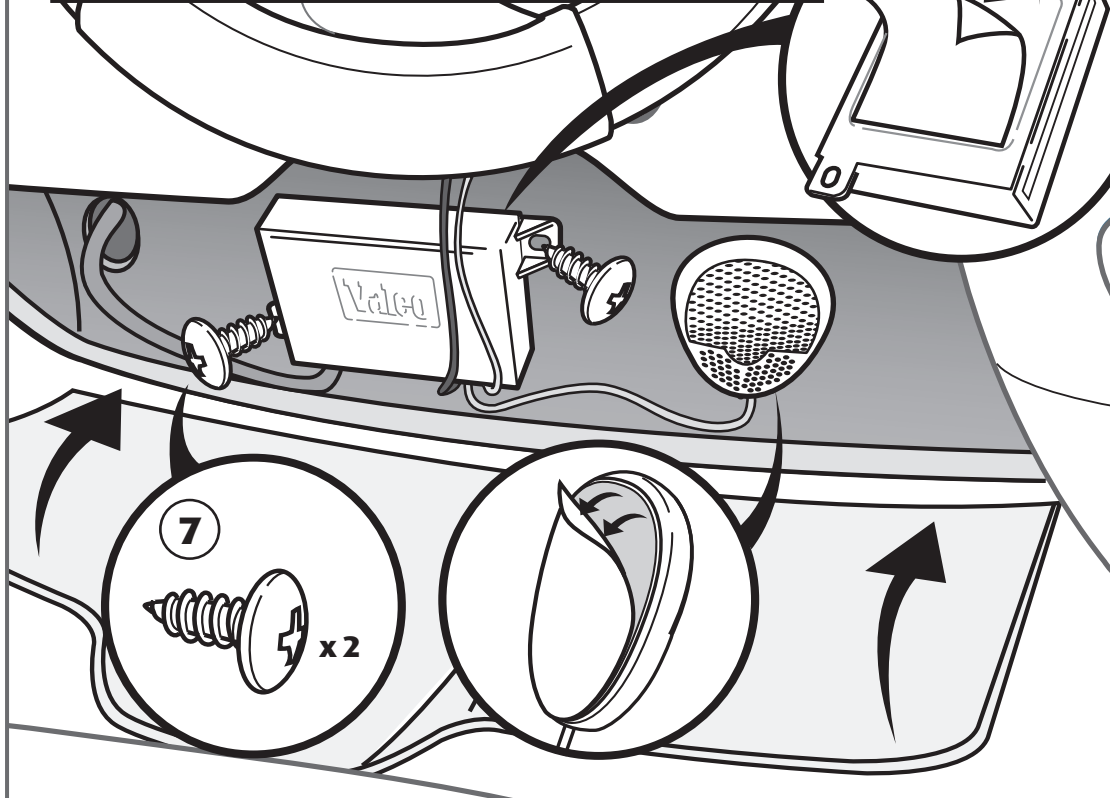
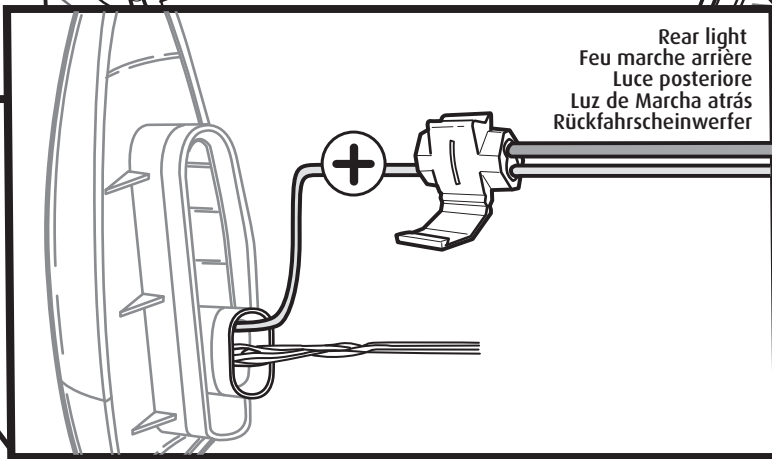

Harness  
Faisceau électrique  
Cavi di collegamento  
Cableado  
Cablagem  
Kabel

**ECU**

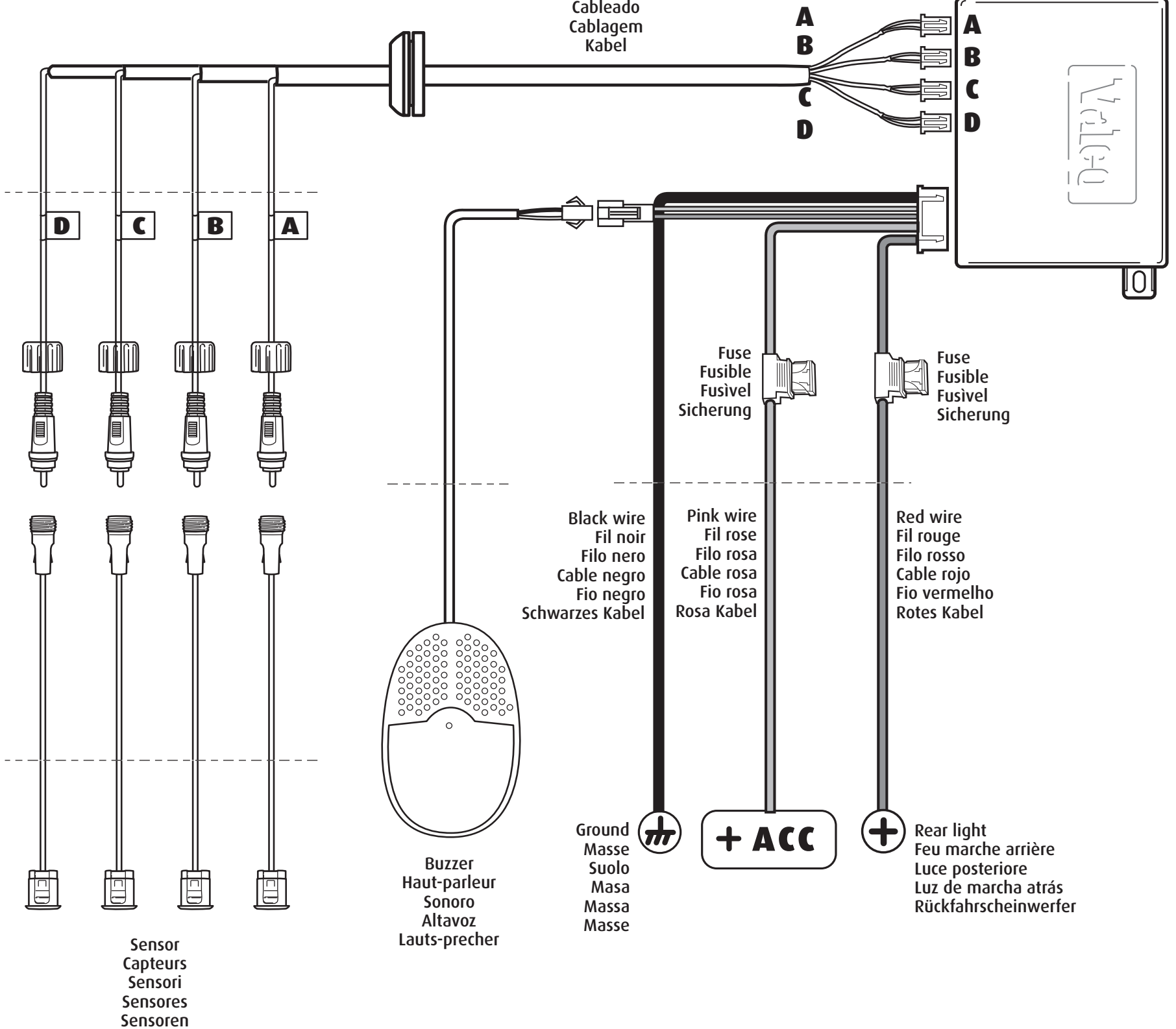

Symptom/Diagnosis • Symptôme/Diagnostic  
Sintomo/Diagnosi • Sintoma/Diagnosis  
Sintoma/Diagnóstico • Symptom/Diagnose

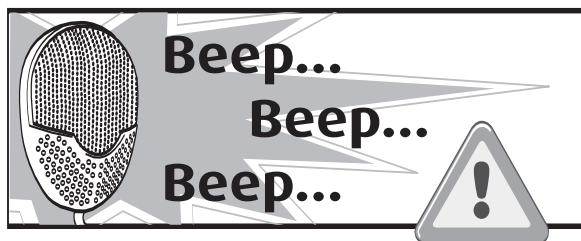

► If the buzzer makes a Beep Beep Beep noise without any obstacles, then it means that one or several sensors have been improperly fitted or damaged.

- Check sensors are properly fitted.
- In case of crash, you can replace the concerned sensor by one available in the Valeo spare parts offer



► Si, en l'absence d'obstacle, le buzzer émet un son Beep Beep Beep, cela signifie qu'un ou plusieurs capteurs ont été mal connectés ou endommagés.

- Vérifiez que les capteurs sont correctement montés.
- En cas de choc, remplacez le capteur défectueux par un capteur disponible dans l'offre Valeo en pièces détachées.



► Se il segnalatore acustico emette Beep Beep Beep senza alcun ostacolo in prossimità del veicolo, significa che uno o più sensori non sono stati montati correttamente oppure sono danneggiati.

- Verificare che i sensori siano stati montati correttamente.
- In caso di urto, è possibile sostituire il sensore danneggiato con uno disponibile nella gamma parti sciolte Valeo.



► Si el zumbador produce un Beep, Beep, Beep sin ningún obstáculo, esto significa que uno o varios sensores han sido incorrectamente montados o dañados.

- Verificar el correcto montaje de los sensores.
- En caso de golpe, es posible sustituir el sensor afectado por otro disponible en la oferta de despiece Valeo.



► Se o som faz um barulho Beep Beep Beep sem obstáculos, isso significa que um ou vários sensores foram mal montados ou danificados.

- Verifique se os sensores estão bem montados.
- Em caso de acidente, pode substituir o sensor danificado por um disponível em Peças de Reparação Valeo.



► Wenn das Gerät ohne in der Nähe eines Hindernisses zu sein 3 Biep-Töne erzeugt, weist dies auf einen oder mehrere falsch angeschlossene oder defekte Sensoren hin.

- Kontrollieren Sie bitte, ob die Sensoren richtig montiert und angeschlossen sind.
- Ein defekter Sensor kann durch einen Sensor aus dem Valeo Ersatzteile-Programm ersetzt werden.

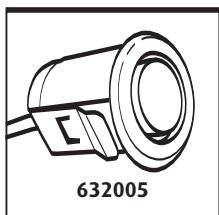

**Valeo**

VALEO SERVICE  
15, rue des Rosiers  
93582 Saint-Ouen Cedex  
France