

Fusing time SAE J-1284 [s]		
Load [%]	Minimum [s]	Maximum [s]
110 %	360,000	-
135 %	0.75	1,800
200 %	0.15	5
350 %	> 0.08	

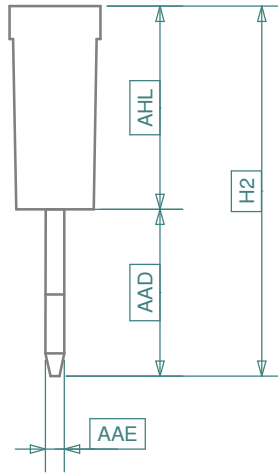
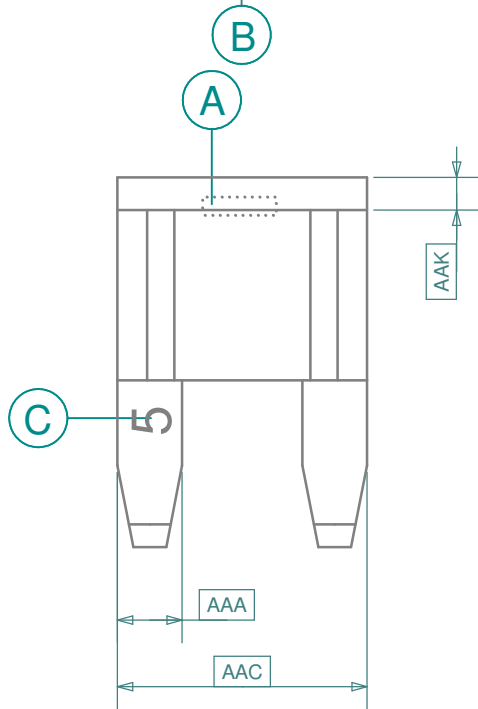

Notes	
A	LED / PCB placement
B	Amperage rating printed on fuse body
C	Amperage rating stamped

Rating	Color	Volt	iMaXX Reference
[ A ]		[ V ]	
2	Gray	32	F7902
3	Violet	32	F7903
4	Pink	32	F7904
5	Tan	32	F7905
7.5	Brown	32	F7975
10	Red	32	F7910
15	Blue	32	F7915
20	Yellow	32	F7920
25	Natural	32	F7925
30	Green	32	F7930

Dimension [mm]		
	iMaXX	DIN 72581-3 (ref.)
AAD	7.0 - 8.0	7.5 ± 0.5
AAE	0.78 - 0.88	0.82 ± 0.04
AAA	2.8 ± 0.2	2.8 ± 0.2
AAC	10.6 - 11.2	10.9 ± 0.3
H1	max. 11.2	max. 12
G3	max. 4.0	max. 4
AHL	max. 9.0	max. 9
AAK	1.5	1.5 ± 0.5
H2	max. 17.0	

Revisions			Date	Appr.
	Date	Type	Drawn	05/09
a	08/11	rating print on top added	Checked	08/11
			Standards	
			Approved	08/11
				AdH



		Scale 3 : 1	Title	F7900 series, miniOTO ShoBlo
		Projection	Drawing type	schematic
			Drawing number	F7900 (LED) drawing 1
			Sheet	1 of 1
			Layers	0 1 2    6    9