

APPROVAL PRINT

Please check print carefully and note any changes or corrections. Customer is responsible for motor specifications and suitability in the application. I have also read and understood document CI-01.01 Tooling required yes no

Signed: _____ Date: _____

PO: S.Sm.26	DATE ISSUED:	PART NAME:	ISS:	E.C.N.	CHANGE	DATE	BY	CHK'D	ROTOR:
MODEL: 2809-531-XXX		D.C.PERM.MAGNET	A		NEW SAMPLE	21.NOV.05	L.J.		C.W.S.E./C.W.C.E./C.W.L.E.
SAMPLE NO: 2113-5B		DRAWN BY: L.J.							ORANGE: +
CUSTOMER NAME: KATA OY AB		CHECKED BY:							PERFORMANCE:
CUSTOMER NO:		MECH.APPR:							13.0V; 6.5 AMPS
		ELECT.APPR: <i>L.J. 21/NOV/05</i>							7.0 OZ.IN. @ 7350 RPM
									END PLAY: NO FREE END PLAY;
									SPRING COMPRESSION .015 - .030

FASCO FASCO MOTORS LIMITED
505 CONESTOGA BLVD.
CAMBRIDGE, ONT. A

ALL UNTOLERANCED DIMENSIONS ARE REFERENCE DIMENSIONS BASED ON STD. MFG. ASSEMBLY

THIS PRINT AND/OR SPECIFICATIONS ARE EXCLUSIVE PROPERTY OF FASCO MOTORS LIMITED AND ARE NOT TO BE REPRODUCED, COPIED, USED, OR DISCLOSED TO ANYONE WITHOUT WRITTEN PERMISSION

UNITS: IMPERIAL
SCALE: HALF

THIRD ANGLE PROJECTION

NAMEPLATE DATA: INSUL. CLASS: H

DATE CODE: [00] [0] YEAR 2003 AND UP
W 1999 DATE CODE: [00] [0] 03 2003
X 2000 WEEK OF YEAR: 01 01 01 01
Y 2001 -52 FIRST -52 LAST
Z 2002 Etc.

YEAR 2003 AND UP
DATE CODE: [00] [0] 03 2003
W 1999 WEEK OF YEAR: 01 01 01 01
X 2000 -52 FIRST -52 LAST
Y 2001 Etc.
Z 2002

FASCO 12V MADE IN CANADA
2809-531-XXX XXXX

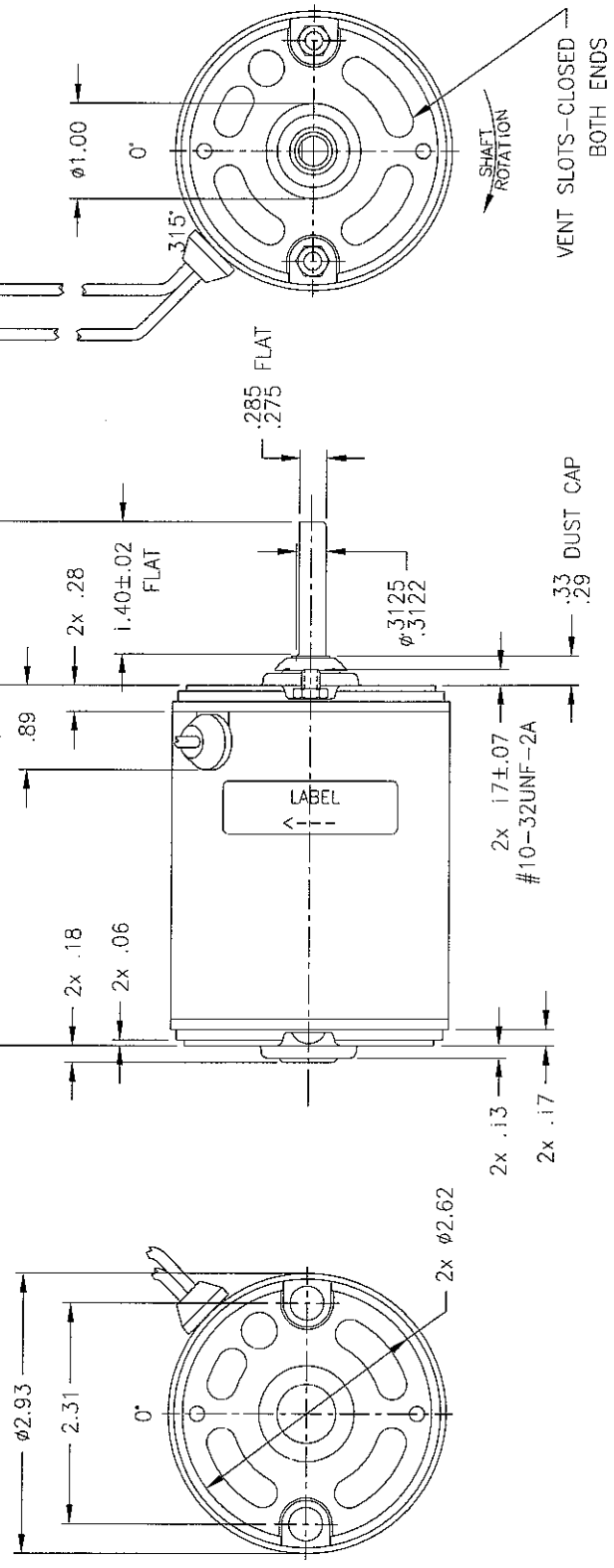

OVERHEATING PROTECTION:

LEAD WIRE TYPE: 14 GA GPT 105°C

BEARING: 608 BALL BEARING

LUBRICANT: LY551

SHAFT MAT'L: 316 STAINLESS STEEL

FINISH: FLUXRING PAINTED BLACK

SPECIAL NOTES:

PACKAGING: STD. EXPORT 20 PER CARTON
480 PER SKID

DO NOT SCALE PRINT

MODEL: 2809-531-XXX

ISSUE: A

UP

HOR.

DOWN

FRONT SHAFT POSITION