

Installation Instructions

Adapterkit ThermoConnect TCon2 and OE Telestart T91

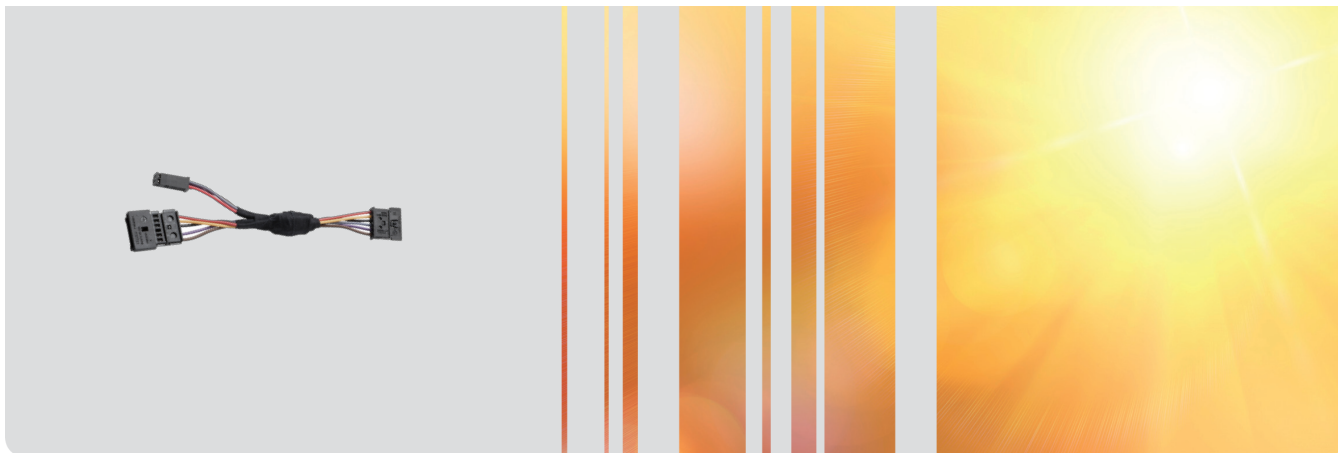

1 Safety information

You use this adapter kit in combination with the ThermoConnect TCon2. The safety instructions for the ThermoConnect TCon2 apply to this kit as well. You find the safety instructions in the installation and operation manual for the ThermoConnect TCon2 device.

2 Scope of Delivery: ThermoConnect TCon2 and OE T91

This adapter kit is an addition for the ThermoConnect TCon2, to install in vehicles with an OE Telestart T91 receiver unit. Install both the ThermoConnect TCon2 and the adapter kit for a functioning system.

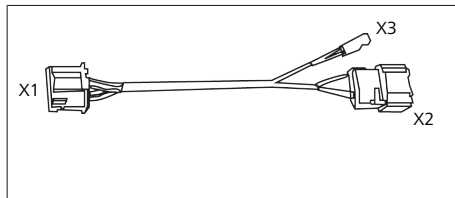

Fig.1 Adapter wiring harness TC1.1 9010325B

3 Installation with OE T91

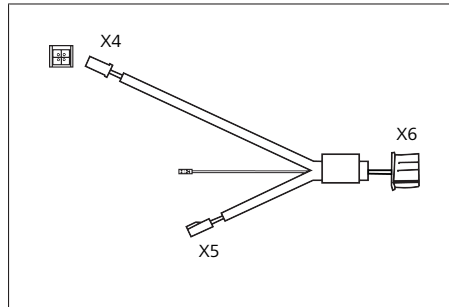

Fig.2 ThermoConnect TCon2 9040222A

Step 1: Disconnect pin 1 from the X4 connector of the ThermoConnect TCon2 wiring harness 9040222A, or pin 1 from the 4-pin connector X3 of the adapter wiring harness 9010325B. (analogue control, without W-bus).

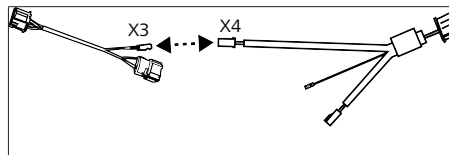

Fig.3 Connect the TCon2 cable to the wiring harness

Step 2: Plug the connector X4 of the ThermoConnect TCon2 wiring harness 9040222A to the 4-pin connector X3 of the adapter wiring harness 9010325B.

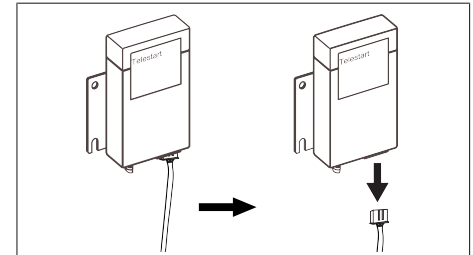

Fig.4 Disconnect Telestart T91

Step 3: Disconnect the OE Telestart T91 receiver from the original wiring harness.

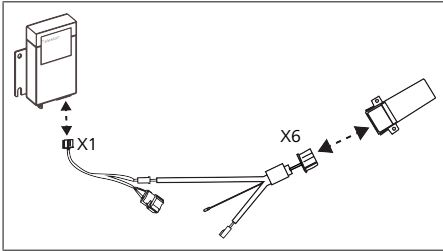

Fig.5 Connect Telestart T91 receiver and ThermoConnect TCon2

Step 4: Plug the X1 connector of the wiring harness 9010325B into the OE Telestart T91 receiver. Plug the ThermoConnect TCon2 into the single connector (X6) of the wiring harness 9040222A to connect with the OE Telestart T91 receiver.

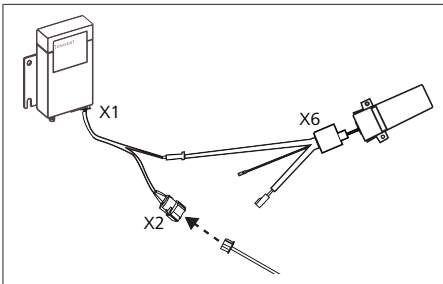

Fig.6 Connect Original cable to X2

Step 5: Plug the cable, that was originally connected to the OE Telestart T91 receiver, to the X2 connector of the wiring harness 9010325B.

4 Settings ThermoConnect

In order to work properly, you must adjust the settings of the ThermoConnect TCon2:

1. Open the My Webasto Connect website in web browser or via smartphone app:
my.webastoconnect.com.
2. Open **Settings** and select the output option **Output 1**.
3. Enable pulse control and adjust the following settings:
-Pulse duration: 1 sec.
-Delay: 3 sec.
4. Confirm with **OK**, and then save your settings.

You must make the switch between heating and ventilation in the vehicle settings. Look in the vehicle's operating instruction for information.



ATTENTION

Switch off the heater, using the same control device used to switch the heater on.



ATTENTION

The maximum duration that the ThermoConnect TCon2 is on must be shorter than the time set in the driver information system.

These are the original instructions. The English language is binding.
You can request your language if it is missing. The telephone number of each country can be found in the Webasto service centre leaflet or the website of the respective Webasto representative of your country.

Webasto Thermo & Comfort SE
Postfach 1410
82199 Gilching
Germany

Company address:
Friedrichshafener Str. 9
82205 Gilching
Germany

www.webasto.com