



Applications

- Improve temperature control in front and/or rear HVAC systems
- Improve performance of stacked core and blend-door HVAC systems
- Control cooling to protect critical components such as batteries/alternators, ECUs or other critical components
- Regulate coolant flow in engine cooling applications (bypass, oil cooler etc.)

Specifications

Operating Supply Voltage	9-16V DC
Current Consumption	Approximately 200 ma
Internal Valve Leakage	10cc per minute max.
Operating Temperature Range Ambient	-40°F to 185° -40°C to 85°C
Operating Temperature Range Coolant	-40°F to 248°F -40°C to 120°C
Storage Temperature Range	-40°F to 185°F -40°C to 85°C
Durability	100K cycles
Construction	Nylon 6/6 glass reinforced

Ranco® offers both internally controlled and externally controlled actuators with two flow options. Both types of actuators are offered in sealed (splash proof) and unsealed versions. Further details on actuators can be obtained from the Invensys Controls Commercial Marketing Team.

The metered versions open the flow passage gradually with actuator rotation which can be useful where flow control is important.

The non-metered versions open faster and to a larger flow area when fully open. (See graph, Metering Options Comparison, on reverse side.)

Features and Benefits

- Available with analog actuator or non-electronic actuator with feedback
- Coolant flow control from fully open/closed non-linear output to reduced flow control linear output (metering)
- Minimal pressure drop in full flow applications
- Port sized available: 1/2" and 17mm (approximately 5/8")
- Integral electrical interface on the actuator (Delphi connectors)
- Under the hood compatible up to 85°C
- Integral mounting bracket

Dimensional Drawings

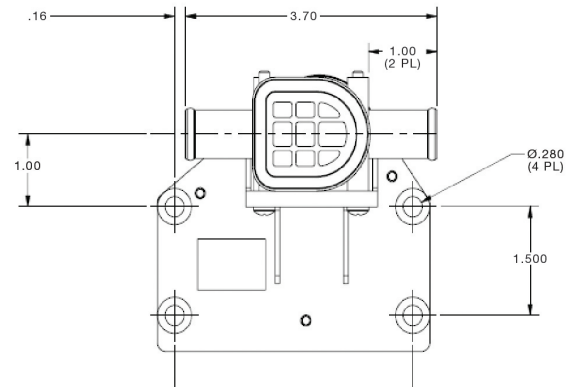
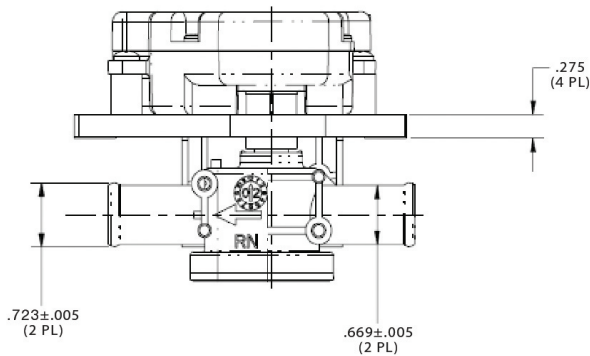

H44 Flow Performance: Metering Options Comparison

