

MOUNTING LOCATION
WITH M8 SPOTNUT
INSIDE (8x)

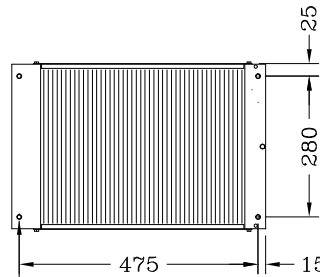

SPECIFICATIONS:

CAPACITY - TO SUPPORT A COOLING CAPACITY
OF 8.7 KW
AIRFLOW - 1950 m³/h
CURRENT - 8.5 AMPS (AT 27V)
WEIGHT - 13 KG

NOTE:

CASING MADE OF 1.5mm SATIN COAT STEEL,
ENDPLATES MADE OF 2mm SATIN COAT STEEL
AND BOTH FINISHED IN BLACK SEMI GLOSS
EPOXY POWDER COAT.

ELECTRICAL CONNECTIONS:

2-WAY MALE WEATHER PACK CONNECTOR,
PACKARD #12010973 (MCC #31-1068)
WITH MALE TERMINAL #12124582-L (2X)
(MCC #31-1039) AND SEAL #12010293
(2X) (MCC #31-1024)

4	1	23-0148	FINGER GUARD	
3E	1	29-0167	"C" CLIP	
3D	3	29-0166	#10-32 HEX. SOCKET CTR. SUNK	
3C	1	25-0746	MOTOR 24V	
3B	1	25-0579	FAN	
MCC-37	3A	1	25-0577	VENTURI
	3	1	15-7552	FAN ASSY. 12V
	2	1	21-0412	CONDENSER COIL
	1	1	24-2892	CASING

SYM	DESCRIPTION	DATE	BY

THIS PRINT IS PROVIDED ON A RESTRICTED BASIS AND IS NOT TO BE USED IN ANY WAY DETRIMENTAL TO THE INTEREST OF MOBILE CLIMATE CONTROL INC.

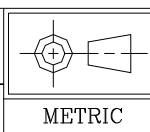

CHECK BY: _____ DATE: _____

MCC Mobile Climate Control Inc.
North York - Ontario - Canada

SYM PCS PART NO. DESCRIPTION

14-0514
CONDENSER 24V

SCALE: NTS	BY: CP
DATE: NOV 14, 1997	
DWG: P3-6058	REV: 0