

# *WPT*

Hand hydraulic pump

---

User's manual



## 1 - INTRODUCTION

The hand hydraulic pump at direct joint is a important change in the hydraulic units.

In fact the tool is composed of a light alloy lever pump with an hydraulic cylinder integrated that releases an hygh capacity by minimum effort on lever.

Like this it is possible to change, every time and without modifications, the crimper operation from manual to hydraulic and to make the crimp directly on the vehicle or outside working area without pneumatic or electrical sources.

## 2 - SAFETY INFORMATION

**! READ THIS SHEET CAREFULLY BEFORE USE.**

**! USE THE PUMP PROPERLY AND ONLY FOR ALL THE CRIMPERS DESIGNED FROM THE MANUFACTURER.**

**! ALWAYS WEAR PROPER PERSONAL PROTECTIVE GEAR WHEN WORKING TOOL.**

**! NEVER PUT THE FACE OVER THE TOOL IN PRESENCE OF HYDRAULIC PRESSURE.**

**! NEVER DIRECT THE TOOL TOWARDS PEOPLE DURING PUMPING OPERATION.**

**! TO AVOID INJURY AND TOOL DAMAGE, DO NOT CONTINUE PRESSURIZING AFTER DIE MATCH.**

**! IN CASE OF TROUBLE TO FINISH A CRIMP, DO NOT CONTINUE PRESS ON THE PUMP LEVER BUT CHECK THE CAUSE OF PROBLEM (FITTING TYPE, DIE SIZE, ETC.).**

## 3 - SPECIFICATIONS

- **Capacity:** 66 kN at 700 bar
- **Piston stroke:** 22 mm
- **Length (w/o thread):** 255 mm
- **Weight:** 1,6 kg

## 4 - JOINING TO CRIMPER

- a. Remove the drive bolt and the bronze washer from the crimper.
- b. Screw, by using the wrench supplied, the pump directly in the lower crimper body instead of the drive bolt (**Fig. 1**).
- c. Slip the bronze washer on the top of the pump piston (**Fig. 2**).

## 5 - OPERATING

For moving the piston, screw the release valve knob and press on the lever until dies match fully. For taking away the hydraulic pressure, unscrew the release valve knob.

## 6 - MAINTENANCE

Periodically blow with compressed air on the pump to clean it from dirty.

## 7 - PUMP DESCRIPTION

**Fig. 3**

- 1 - Piston stem
- 2 - Threaded ring nut adapter
- 3 - Point for wrench
- 4 - Cylinder ring nut
- 5 - Lever fulcrum
- 6 - Lever pins
- 7 - Snap rings
- 8 - Piston
- 9 - Pumping lever
- 10 - Vent hole
- 11 - Reservoir cap
- 12 - Handle/Oil reservoir
- 13 - Release valve knob
- 14 - Knob stop
- 15 - Fixing wrench

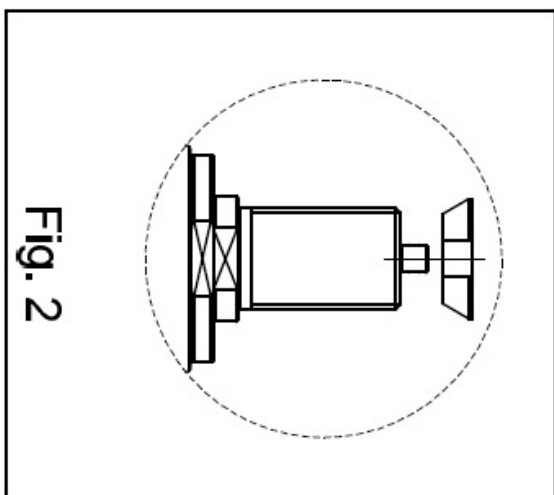

Fig. 2

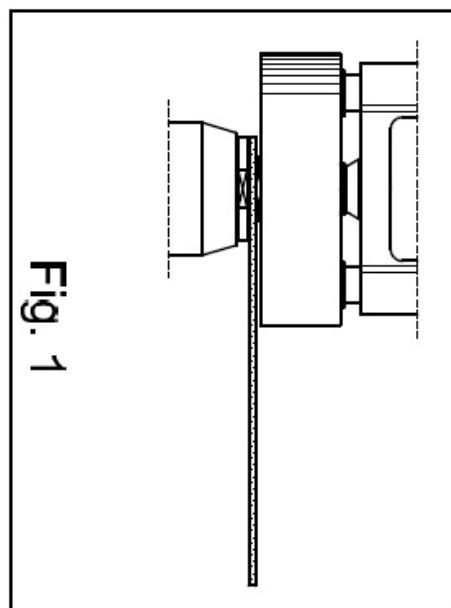

Fig. 1

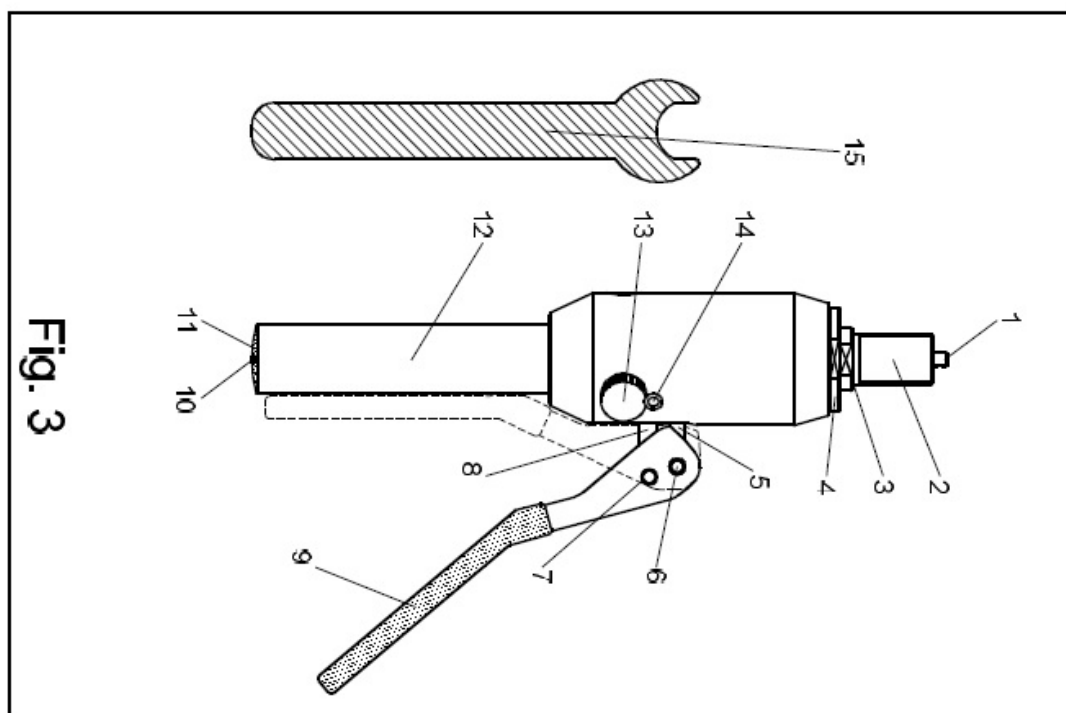

Fig. 3

